

TRENT OUTDOOR IP44 WALL / FLUSH

These instructions are provided for your safety.

Please read carefully before commencing work and retain for future reference.

This fitting has an IP rating of IP44 and is suitable for outdoor use when connected as instructed.

SAFETY INFORMATION

- * If you are in any doubt consult a person competent to give advice on the installation of electrical equipment.
- * We recommend any electrical wiring in an outdoor environment is carried out by a qualified electrician. All wiring must comply with the current edition of the IEE wiring regulations and any relevant Building Regulations.
- * This fitting is Class I = $\frac{1}{\text{I}}$ and should be fitted to a lighting supply (with earth) protected by a 5 amp fuse or equivalent circuit breaker. Product should be connected to a supply protected by a 30mA RCD.
- * Before installation and servicing disconnect the electricity supply at the fuse board.
- * To avoid damage to concealed wiring during installation, establish the direction of the supply cable before drilling fixing holes.
- * Always be sure to use the correct type and wattage of bulbs as indicated on the fitting.
- * When changing the bulb, always switch off from the mains and allow old bulb to cool down before handling. Dispose of used bulbs carefully.

INSTALLATION

Note: This fitting has a 3 year guarantee against corrosion. This fitting should only be installed in normal non aggressive atmospheric locations to prevent corrosion. Aggressive environments to be avoided include locations by the sea, polluted atmospheres or near heating flue outlets.

1. Ensure house electricity supply is off at the fuse board.
2. If removing an existing fitting, first note down all wiring connections.
3. Release backplate from main body by undoing 4 x retaining screws, retain screws for later.
4. Using backplate as a template, mark and then drill the fixing holes in the wall or ceiling. Make sure the cable is aligned with rubber grommet. (Located at the rear of backplate- terminal block housing) Ensure fixing holes are located on a solid, suitable surface.
5. Remove terminal block housing by undoing 2 x hex head nuts, (facia of fitting) retain the hex screws and nuts for later.
6. Make a suitable size hole in the rubber grommet at the top of backplate then pass cable from the wall through grommet in the backplate ensuring it makes a good watertight seal around cable.
7. Make electrical connections as follows.
Connect supply live (normally brown or red) to terminal block (marked "L" or brown) on fitting.
Connect supply neutral (normally blue or black) to terminal block (marked "N" or blue) on fitting.
Connect supply earth (Green and Yellow) to the centre terminal of terminal block (marked " $\frac{1}{\text{I}}$ " or green/ yellow) on fitting.
Ensure electrical connections are tight and no loose strands of wire are left out of the block.
8. Reattach terminal block housing onto the backplate using the hex screws and nuts, ensure the screws are sufficiently tight.
9. Attach backplate to the wall or ceiling with suitable screws and **take care not to damage wiring.**
10. **Fit bulb**, type and wattage as indicated on fitting. **The wattage indicated must not be exceeded.**
Offer main body over the backplate then secure into position with 4 x screws removed earlier. Ensure the main body of the fitting is evenly tightened onto the backplate and rubber seals on the backplate have been compressed evenly.
Note: Ceiling light – remove 2 x plastic caps located opposite sides of the glass frame
11. Switch on the electricity supply at the fuse board.

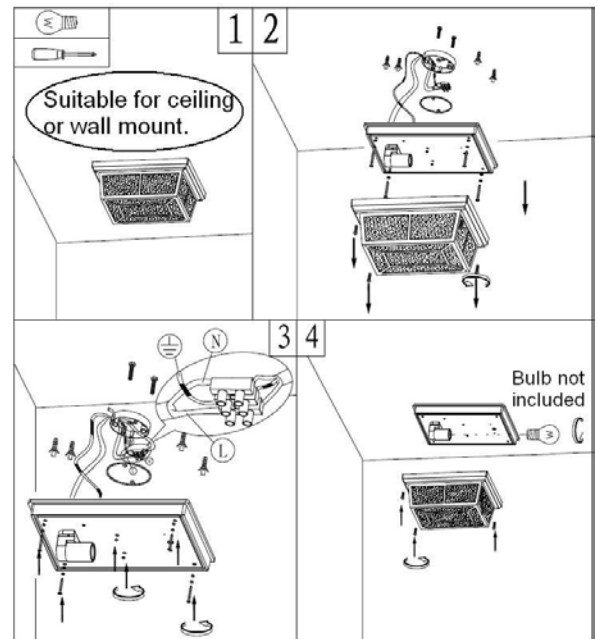

GENERAL INFORMATION

This fitting is designed for external use, it must be fitted to a DRY FINISH as any dampness in concrete, wood stain, paint and etc can damage finish. **Do not use polish or abrasive cleaner - just a soft slightly damp cloth**