

ZELDA G9 CEILING FITTING INSTALLATION INSTRUCTIONS

These instructions are provided for your safety.

Please read carefully before commencing work and retain for future reference.

SAFETY INFORMATION

- * If you are in any doubt consult a person competent to give advice on the installation of electrical equipment.
- * This fitting should be fitted in accordance with IEE Wiring Regulations and the Building Regulations
- * To prevent electrocution switch off at the mains supply before installing or maintaining this fitting. Ensure other persons cannot restore the electricity supply without your knowledge.
- * To avoid damage to concealed wiring during installation, establish the direction of the supply cable before drilling fixing holes.
- * This fitting is Class I = \equiv and should be fitted to a lighting supply (with earth) protected by a 5 amp fuse or equivalent circuit breaker.
- * Always be sure to use the correct type and wattage of bulbs as indicated on the fitting. Never exceed the wattage stated.
- * When changing the bulb, always switch off at the mains and allow the old bulb to cool down before handling. Dispose of used bulbs carefully.
- * This fitting is designed for use with self-shielded tungsten halogen lamps only = 

INSTALLATION

1. Ensure the house electricity supply is off at the fuse board.
2. Before removing the existing rose, carefully note the position of each set of cables. If there are loop in cables that are not connected to the light these must be terminated in a separate terminal block not connected to the fitting.
3. Remove mounting bracket from fitting by undoing retaining screws ① and retain screws and any washers for later.
4. Using mounting bracket as a template, mark and drill the fixing holes in the ceiling. ② Ensure that the holes are drilled into a joist or other suitable mounting and not just into plaster.
5. Fix the mounting bracket to ceiling with suitable fixings. ③ **Take care not to damage wiring.**
6. Use a screwdriver to lever open the connector block housing and feed supply cable through the rubber sleeve then make the electrical connections as follows: ④

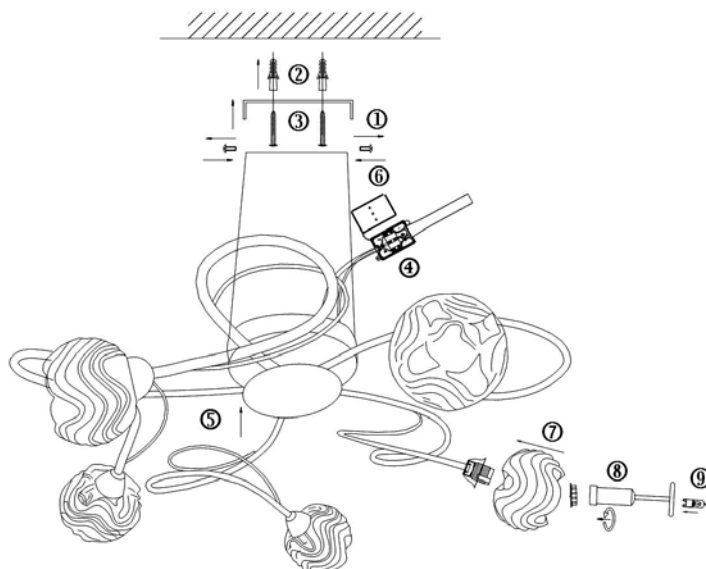

Connect the supply live (normally brown or red) to fitting live (marked "L") on the terminal block.
Connect the supply neutral (normally blue or black) to fitting neutral (marked "N") on the terminal block.
Connect the earth (normally green/yellow or unsheathed) to terminal block marked \equiv on the fitting.

Ensure electrical connections are tight and no loose strands of wire are left out of the terminal block. Ensure terminals and rubber sleeve is correctly seated then close connector block housing by snapping together.

7. Offer the fitting onto the mounting bracket ⑤ and align the holes, secure into position using the retaining screws and any washers removed earlier. ⑥ **Take care not to trap wires in the process.**
8. **Fit glass shades**, remove the shade ring from the lamp holder and attach this onto the shade fitting tool, fit the glass and secure into position by using the shade ring ⑦ attached to fitting tool. ⑧ **Do not over tighten.**
9. Fit the bulb, type and wattage as indicated on the fitting. ⑨  **Always use self-shielded bulbs.** Do not touch halogen bulbs with bare hands, as this will shorten their life.
10. Switch on the electricity supply at the fuse board.

GENERAL INFORMATION

This fitting is designed for internal use only and must be fitted to a DRY SURFACE as any dampness in plaster or paint can damage the finish. **Do not use polish or abrasive cleaner - just a soft dry cloth.**